

CERTIFIED LAND CORNER RECORDATION

DESCRIPTION OF CORNER EVIDENCE FOUND, AND ORIGINAL RECORD (If known)

Found 12"X10"X8" red stone with railroad spike.

DESCRIPTION OF MONUMENT AND ACCESSORIES ESTABLISHED TO PERPETUATE THE ORIGINAL LOCATION OF THIS CORNER:

12"X10"X8" red stone with railroad spike in ground at west face left in original condition as found.

SKETCH, WITH COURSE AND DISTANCE TO ADJACENT CORNER IF DETERMINED IN THIS SURVEY. (May Sketch or Paste Reproduction on Reverse Side.)

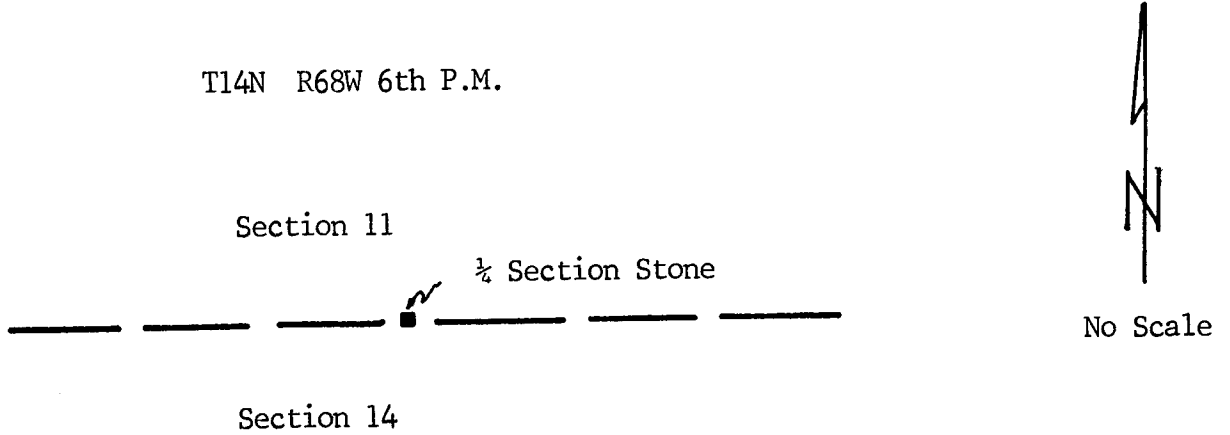

I, Albert L. Scott certify that I have carefully performed or reviewed the work done on the diagrammed corner as reported on this recordation form and approve the same.

Albert L. Scott  
Signature of Surveyor

L.S. 2573  
Registration No.

STATE OF WYOMING,  
Office of Clerk and Recorder,  
County of \_\_\_\_\_

567540

This "corner record" was filed for record on the \_\_\_\_\_ day of FEB 12 1980, 19\_\_\_\_, was noted on the cross-index plat and is assigned page No. \_\_\_\_\_, in book No. \_\_\_\_\_.

James C. Whitehead  
County Official

Cross Index No.	<u>J19</u>	T.	<u>14N</u>	R.	<u>68W</u>	Mer.	6th P.M.
_____	_____	T.	_____	R.	_____	Mer.	
_____	_____	T.	_____	R.	_____	Mer.	
_____	_____	T.	_____	R.	_____	Mer.	
_____	_____	T.	_____	R.	_____	Mer.	
_____	_____	T.	_____	R.	_____	Mer.	
_____	_____	T.	_____	R.	_____	Mer.	

J-19 14-68